

EDDY'S AUTO CENTER

6845 HWY 10, RAMSEY, MN 55303

FOR SALE

17,010 SF ON 4 ACRES



PROPERTY DETAILS

FOR SALE: \$1,737,000.00

- 120 - 160 PARKING STALLS
- 17,010 SF BUILDING ON 4 ACRES
- CURRENTLY USED FOR AUTOMOTIVE SALES, AUTO SERVICE AND AUTO BODY
- 12 DRIVE IN DOORS (14' TALL AND 12' TALL) POTENTIAL DOCK ACCESS
- PERMITS IN PLACE FOR AUTOMOTIVE USE WHICH STAY WITH THE PROPERTY
- GREAT VISIBILITY ON HWY 10
- 1 MILE FROM RAMSEY TOWN CENTER



JEFF SALZBRUN
612-788-1552
jeffs@essencerealestate.com

JEFF NORDNESS
651-341-5044
jeff@essencerealestate.com

OFFICE: 651-482-1871

ERSI

ESSENCE
REAL ESTATE
SERVICES INC.

COMMERCIAL REAL ESTATE SINCE 1990

EDDY'S AUTO CENTER

6845 HWY 10, RAMSEY, MN 55303

FOR SALE

PHOTOS



JEFF SALZBRUN
612-788-1552
jeffs@essencerealestate.com

JEFF NORDNESS
651-341-5044
jeff@essencerealestate.com

OFFICE: 651-482-1871

ERSI

ESSENCE
REAL ESTATE
SERVICES INC.

COMMERCIAL REAL ESTATE SINCE 1990

EDDY'S AUTO CENTER

6845 HWY 10, RAMSEY, MN 55303

FOR SALE

FLOOR PLAN

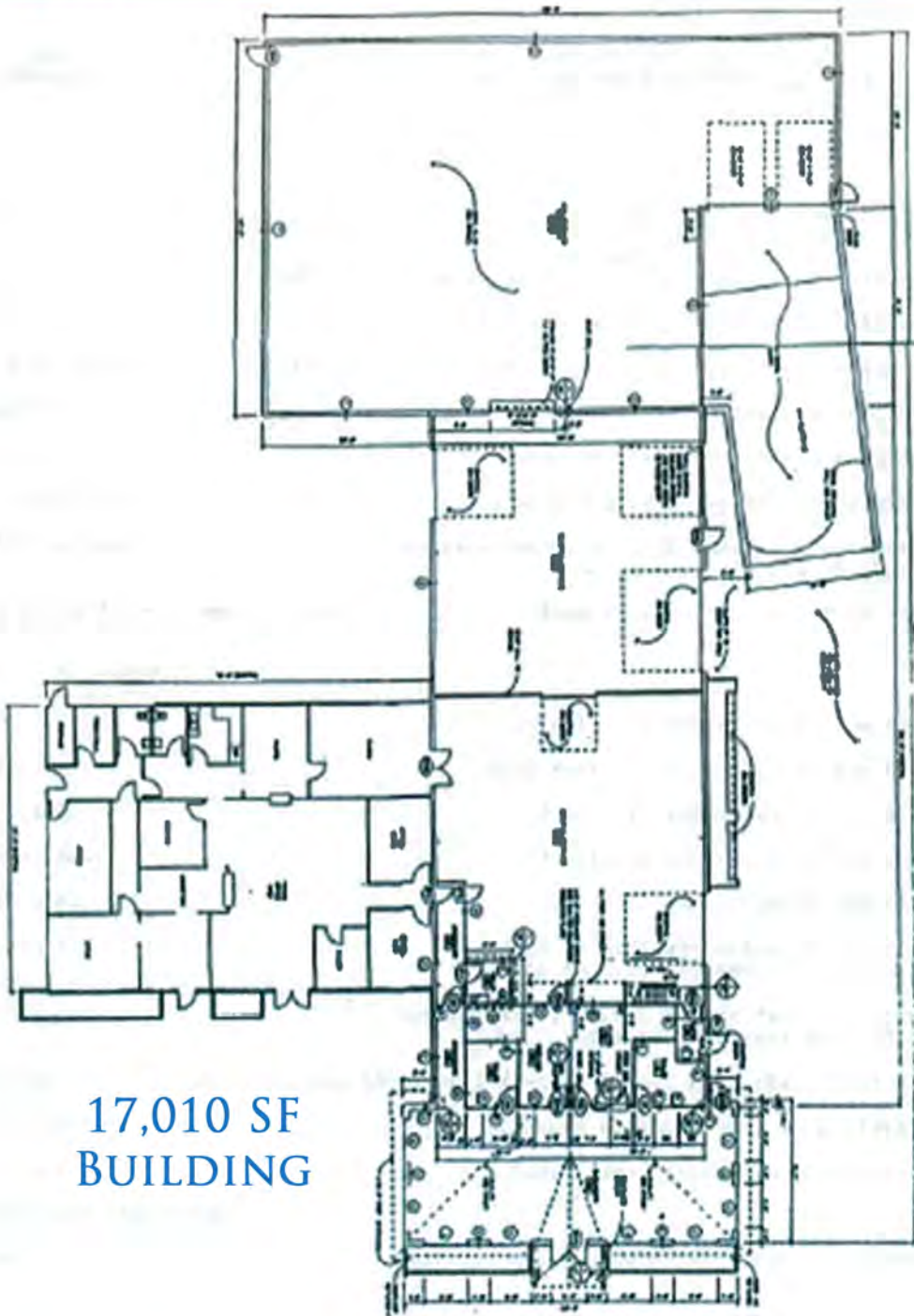

17,010 SF
BUILDING

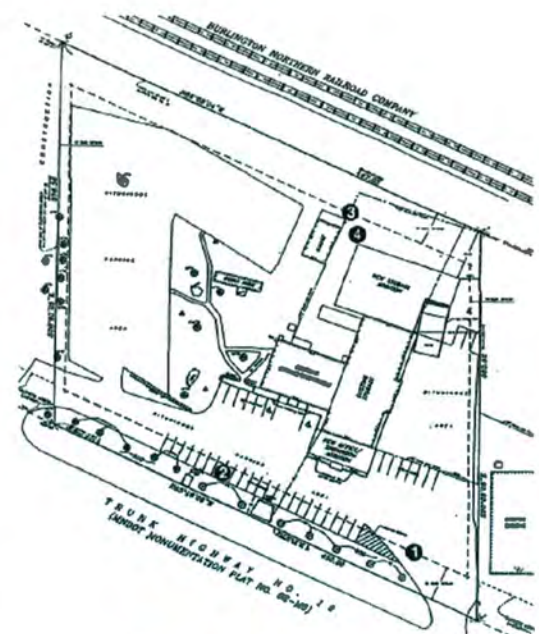

SITE PLAN
4 ACRES

JEFF SALZBRUN
612-788-1552
jeffs@essencerealestate.com

JEFF NORDNESS
651-341-5044
jeff@essencerealestate.com

OFFICE: 651-482-1871

ERSI

ESSENCE
REAL ESTATE
SERVICES INC.

COMMERCIAL REAL ESTATE SINCE 1990